

# TURNBUCKLE TOGGLE

## UNF THREAD, 316 STAINLESS STEEL



Import



Precision  
Machined



Stamped

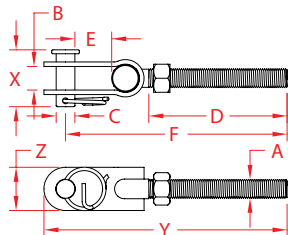

ITEM	A (size)	B	C	D	E	F	X (height)	Y (length)	Z (width)	WLL (lb)	WT (lb)	PACKAGING TYPE	EACH (qty)	INNER (qty)	CARTON (qty)	UPC
<b>RIGHT HAND, UNF</b>																
P0780-RT05	3/16"	0.25"	0.19"	1.90"	0.58"	3.00"	0.74"	3.25"	0.51"	240	0.05	POLYBAG	1	25	500	791506026198
P0780-RT07	1/4"	0.37"	0.23"	2.38"	0.45"	3.41"	0.82"	3.70"	0.59"	550	0.09	POLYBAG	1	25	350	791506026204
P0780-RT09	5/16"	0.39"	0.31"	2.45"	0.61"	3.95"	0.90"	4.35"	0.80"	860	0.18	POLYBAG	1	25	200	791506026211
P0780-RT10	3/8"	0.52"	0.37"	2.63"	0.75"	4.35"	1.12"	4.86"	0.87"	1,700	0.26	POLYBAG	1	10	200	791506026228
P0780-RT13	1/2"	0.59"	0.47"	3.20"	0.62"	5.60"	1.30"	5.92"	1.20"	2,060	0.53	POLYBAG	1	10	80	791506026235
P0780-RT16	5/8"	0.79"	0.62"	4.13"	0.83"	6.65"	1.68"	7.37"	1.42"	2,800	1.21	POLYBAG	1	5	40	791506026242
<b>LEFT HAND, UNF</b>																
P0780-LT05	3/16"	0.25"	0.19"	1.90"	0.58"	3.00"	0.74"	3.25"	0.51"	240	0.05	POLYBAG	1	25	500	791506026068
P0780-LT07	1/4"	0.37"	0.23"	2.38"	0.45"	3.41"	0.82"	3.70"	0.59"	550	0.09	POLYBAG	1	25	350	791506026075
P0780-LT09	5/16"	0.39"	0.31"	2.45"	0.61"	3.95"	0.90"	4.35"	0.80"	860	0.18	POLYBAG	1	25	200	791506026082
P0780-LT10	3/8"	0.52"	0.37"	2.63"	0.75"	4.35"	1.12"	4.86"	0.87"	1,700	0.26	POLYBAG	1	10	200	791506026099
P0780-LT13	1/2"	0.59"	0.47"	3.20"	0.62"	5.60"	1.30"	5.92"	1.20"	2,060	0.53	POLYBAG	1	10	80	791506026105
P0780-LT16	5/8"	0.79"	0.62"	4.13"	0.83"	6.65"	1.68"	7.37"	1.42"	2,800	1.21	POLYBAG	1	5	40	791506026112

**NOTE:**  
**USE WITH "CLOSED" TURNBUCKLE BODY (P0780-BD).**  
**ALL DIMENSIONS ARE NOMINAL (+/- 3%) AND ARE SUBJECT TO CHANGE WITHOUT NOTICE.**